

# US-LT30&LT30L SERIES SCREW DRIVERS

## EXPLODED VIEW

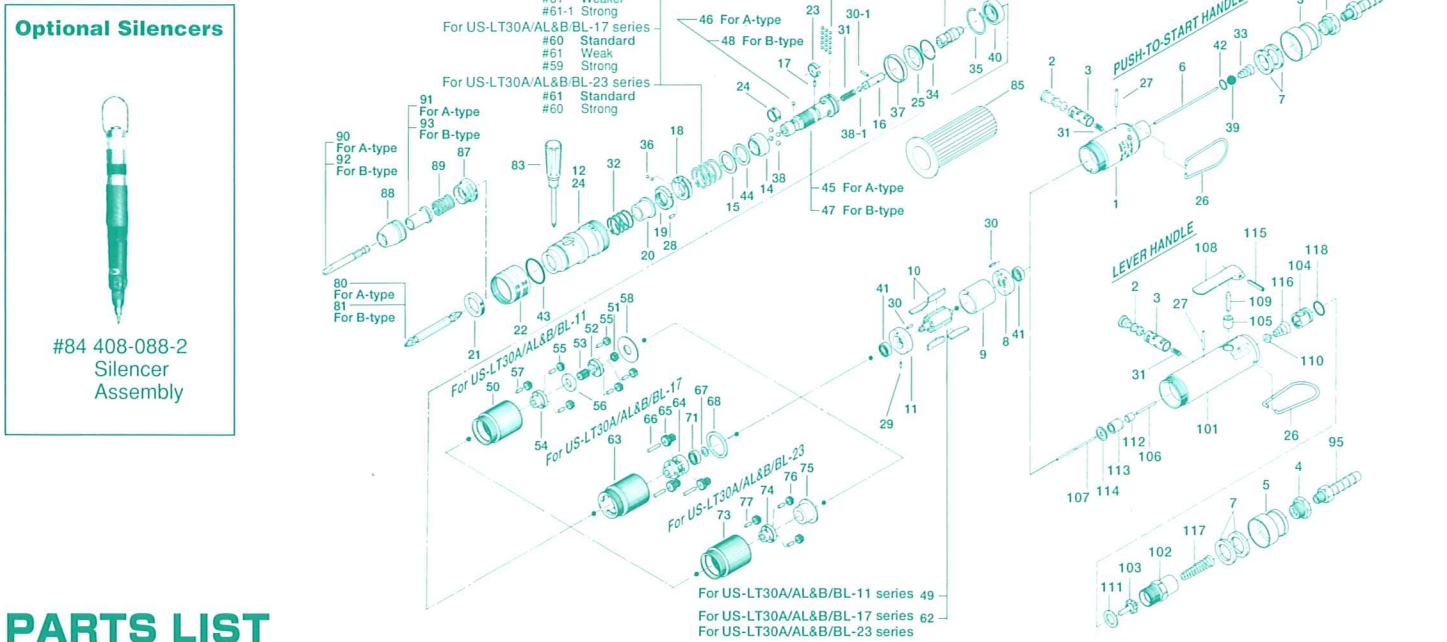

## PARTS LIST

Index No.	Code No.	Parts Name	Quantity	Index No.	Code No.	Parts Name	Quantity	Index No.	Code No.	Parts Name	Quantity
<b>US-LT30 SERIES PUSH-TO-START HANDLE</b>											
# 1	471-025-8	Casing	1	# 9	471-286-7	Cylinder	1	#58	975-178-0	Spacer (26×10×1.5)	1
# 2	893-056-1	Reverse Valve (Locking)	1	#10	471-288-0	Blade	4	#59	976-472-0	Spring (20.6×22) Standard	1
# 3	471-211-7	Reverse Valve Bushing	1	#11	471-289-7	Front Plate	1	#60	976-493-0	Spring (20.8×22) Weak	1
# 4	480-091-8	Air Inlet Bushing	1	#13	471-346-5	Cam	1	#61	976-471-0	Spring (19.4×22) Weaker	1
# 5	408-782-1	Exhaust Deflector	1	#14	471-375-8	Cam Ring	1	#61-1	976-504-0	Spring (21×22) Strong	1
# 6	471-104-7	Valve Rod	1	#15	471-164-8	Spring Setter	1	<b>Parts for US-LT30A/AL-17 and 30B/BL-17</b>			
# 7	471-835-5	Filter (K100)	2	#16	471-318-5	Pilot Pin	1	#62	471-287-5	Rotor	1
#26	401-790-1	Suspension Ring	1	#17	471-764-7	Notch Pin	1	#63	471-029-5	Gear Casing	1
#27	972-020-0	Roller Pin (2×19.8)	1	#18	471-562-7	Retainer	1	#64	471-480-5	Gear Cage	1
#31	976-058-0	Spring (4.5×11)	2	#19	471-257-7	Regulating Screw	1	#65	471-470-6	Planet Gear	3
#33	977-157-0	Cone Spring (7×11×20)	1	#20	471-351-6	Bit Sleeve	1	#66	972-036-0	Roller Pin (2.5×15.8)	3
#39	981-208-0	Ball (5/16)	1	#21	471-567-6	Bushing	1	#67	975-009-0	Spacer (9×5.2×0.3)	1
#42	990-004-0	O Ring (P-6)	1	#22	471-370-7	Clutch Casing Sleeve	1	#68	975-188-0	Spacer (26×20×1.5)	1
#12	471-369-7	Clutch Casing	1	#23	471-670-7	Band	1	#71	987-013-0	Mini. Ball Bearing (R1350)	1
<b>US-LT30L SERIES LEVER HANDLE</b>											
#101	469-025-5	Casing	1	#24	471-356-7	Bit Band	1	#60	976-493-0	Spring (20.8×22) Standard	1
# 4	480-091-8	Air Inlet Bushing	1	#25	970-091-0	Anvil Spacer	1	#61	976-471-0	Spring (19.4×22) Weak	1
#102	461-097-6	Air Inlet Connector	1	#28	970-091-0	Pin (H)(2×4.5)	1	#59	976-472-0	Spring (20.6×22) Strong	1
#103	259-100-0	Valve	1	#29	973-001-0	Roll Pin (1.5×6)	1	<b>Parts for US-LT30A/AL-23 and 30B/BL-23</b>			
#104	461-102-6	Valve Bushing	1	#30	973-003-0	Roll Pin (1.5×8)	2	#62	471-287-5	Rotor	1
#105	553-103-1	Valve Rod Bushing	1	#30-1	969-470-0	Pin (2×8)	1	#63	471-029-5	Gear Casing	1
#106	970-105-0	Pin (H)(2×24)	1	#32	976-450-0	Spring (18.5×10)	1	#64	471-480-3	Gear Cage	1
#107	462-104-7	Valve Rod	1	#34	978-185-0	Snap Ring (19×1)	1	#74	471-480-3	Gear Cage	1
#108	466-107-5	Valve Lever	1	#35	978-229-0	Snap Ring (23×1)	1	#75	471-483-3	Gear Cage Spacer	1
#109	469-114-5	Valve Pin	1	#36	981-001-0	Ball (3/32)	17	#76	471-470-3	Planet Gear	3
#110	259-254-0	Shut-Off Valve	1	#38	981-003-0	Ball (5/32)	4	#77	972-033-0	Roller Pin (2.5×8)	3
#111	996-424-0	Packing	1	#38-1	981-004-0	Ball (3/16)	1	#61	976-471-0	Spring (19.4×22) Standard	1
#112	444-106-8	Valve Rod Cap	1	#40	982-901-0	Ball Bearing (6900)	1	#60	976-493-0	Spring (20.8×22) Strong	1
#113	461-567-6	Bushing	1	#41	987-041-0	Mini. Ball Bearing (R1350ZZ)	2	<b>ACCESSORIES</b>			
# 2	893-056-1	Reverse Valve (Locking)	1	#43	990-919-0	O Ring (SNS-22)	1	#80	916-710-0	Double Bit (No.2×70) for A-type1	1
# 3	471-211-7	Reverse Valve Bushing	1	#44	944-016-0	Back-up Ring (P-16)	1	#81	916-810-0	Double Bit (No.2×75) for B-type1	1
# 5	408-782-1	Exhaust Deflector	1	<b>Parts for US-LT30A &amp; 30AL series</b>							
# 7	471-835-5	Filter (K100)	2	#45	471-319-5	Anvil	1	#82	940-113-0	Air Hose Nipple	1
#114	469-291-5	Rear Plate Spacer	1	#46	981-003-0	Ball (5/32)	1	#83	939-402-0	Manual Driver No. 2	1
#26	401-790-1	Suspension Ring	1	<b>Parts for US-LT30B &amp; 30BL series</b>							
#27	972-020-0	Roller Pin (2×19.8)	1	#47	471-319-2	Anvil	1	#84	408-088-2	Silencer Assembly	1
#115	973-118-0	Roll Pin (3×18)	1	#48	981-002-0	Ball (1/8)	1	#85	471-083-7	Casing Protector	1
#31	976-058-0	Spring (4.5×11)	2	<b>Parts for US-LT30A/AL-11 and 30B/BL-11</b>							
#116	977-071-0	Cone Spring (5.5×11.5×15)	1	#49	471-287-7	Rotor	1	<b>For Slotted Head Bit and Finder</b>			
#117	977-155-0	Cone Spring (7×10×35)	1	#50	471-029-7	Gear Casing	1	(Remove #21 471-567-6 Bushing and use following)			
#118	990-911-0	O Ring (SNS-12)	1	#51	471-460-7	Rotor Gear	1	#87	471-082-7	Bit Casing Set Screw	1
#24	462-369-7	Clutch Casing	1	#52	471-480-7	First Gear Cage	1	#88	471-057-7	Bit Casing	1
#37	462-397-7	Gear Casing Flange	1	#53	471-445-7	Middle Gear	1	#89	976-330-0	Spring (13.8×18×0.8)	1
<b>Common Parts</b>											
# 8	471-285-7	Rear Plate	1	#54	471-485-7	Second Gear Cage	1	#90	916-020-0	(-) Bit (4×51) for A-type	1
				#55	471-471-7	Second Planet Gear	6	#91	917-299-0	Finder for A-type	1
				#56	471-483-7	Gear Cage Spacer	1	#92	916-030-0	(-) Bit (5×56) for B-type	1
				#57	972-033-0	Roller Pin (2.5×8)	6	#93	917-350-0	Finder for B-type	1

When ordering spare parts, please specify tool type, code number and part name.

Printed in Japan



**URYU SEISAKU, LTD.** Osaka Japan

For further information, please contact at any time your nearest URYU distributor.

OKA-248-12-01-13-2001